

CONNECT...



**WYNDHAM GRAND**  
LONDON CHELSEA HARBOUR

...IN A PERFECT SPACE



From large-scale conferences and high-level board meetings to glittering parties and society weddings, the Wyndham Grand London has the perfect space. Bathed in natural daylight and with panoramic views over Chelsea Harbour, our glorious Grand Ballroom offers a spectacular glass-fronted setting for up to 800 guests, while our exclusive Penthouse meeting rooms can host up to 80 delegates. And with exceptional dining, luxurious surroundings and exemplary personal service, you are guaranteed a day to remember.



## PENTHOUSE MEETINGS



Perfect for small gatherings and board meetings, our Penthouse level houses the Bridges, Albert and Battersea meeting rooms, as well as The Boardroom. Combining panoramic river views with a chic neutral colour scheme, our Penthouse meeting rooms can host up to 80 delegates theatre-style and boast plasma screens and projectors. Exclusivity and privacy are on offer in our Penthouse level Executive lounge, and the contemporary ambience of the Chelsea Riverside Brasserie is ideal for executive dining.





Drakes

## HARBOURSIDE CONFERRING



One of London's most impressive conference venues, our Grand Room offers a new perspective on riverside luxury. With a capacity for receptions for up to 800 or 400 theatre-style, this infinitely flexible space can also seat 500 diners. The Grand Foyer can accommodate 500 reception guests, while our three Grand Boardrooms offer exclusive venues for up to ten delegates. However lavish or intimate your event, our marina level conference space can adapt to create the ultimate backdrop.

EVENTS CHELSEA-STYLE



Imbued with a sense of Chelsea chic, the Wyndham Grand London offers an iconic setting for product launches, awards ceremonies and special celebrations. Sweeping through the grand foyer to our impeccable Grand Room, your guests will tingle with a sense of excitement and privilege. Our creative chefs will design the perfect menu while our experienced Sommelier will select wines to complement every flavour. Meanwhile, our discreetly attentive staff will attend to every detail.



Grand Room



Private dining

## OCCASIONS TO REMEMBER

Unique in offering natural daylight and panoramic Thames views, our glass-fronted Grand Room can seat up to 450 wedding guests in breathtaking style. Bespoke lighting co-ordinates effortlessly with your chosen colour scheme, while world-class cuisine, hand-picked wines, delightful table settings and luxurious Penthouse accommodation combine to create a sumptuous wedding day without parallel.



Our dedicated Wedding Planner is available to manage every element of your day, and our Wyndham boat can collect your guests or even host your reception. More intimate weddings and celebrations for up to twelve guests can be toasted in the cocooned environment of our private dining room.

FLOORPLANS

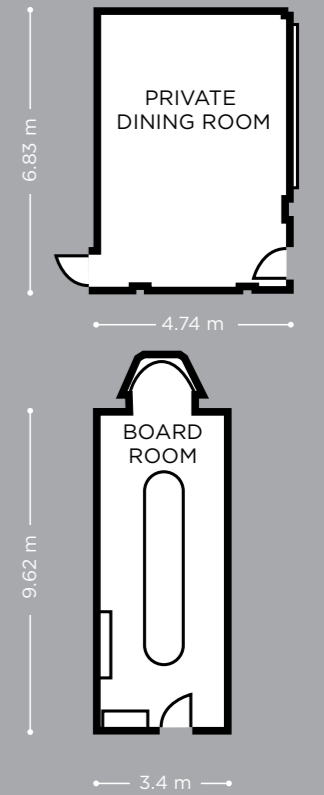
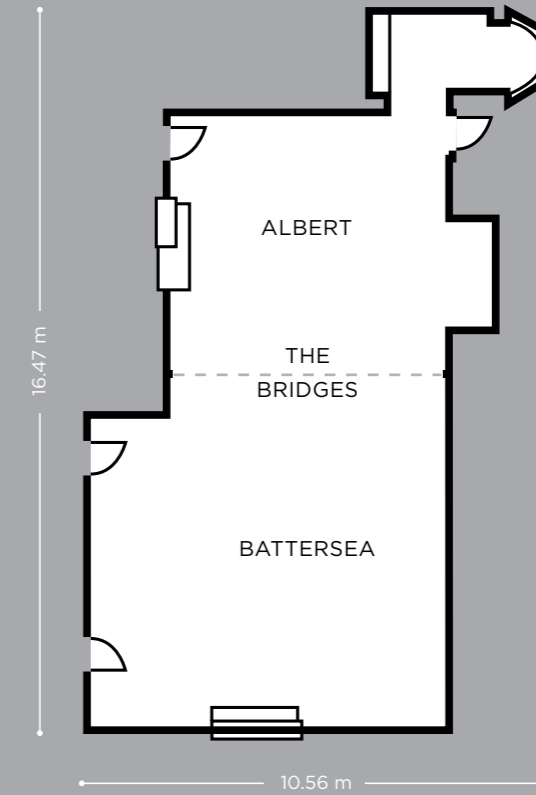
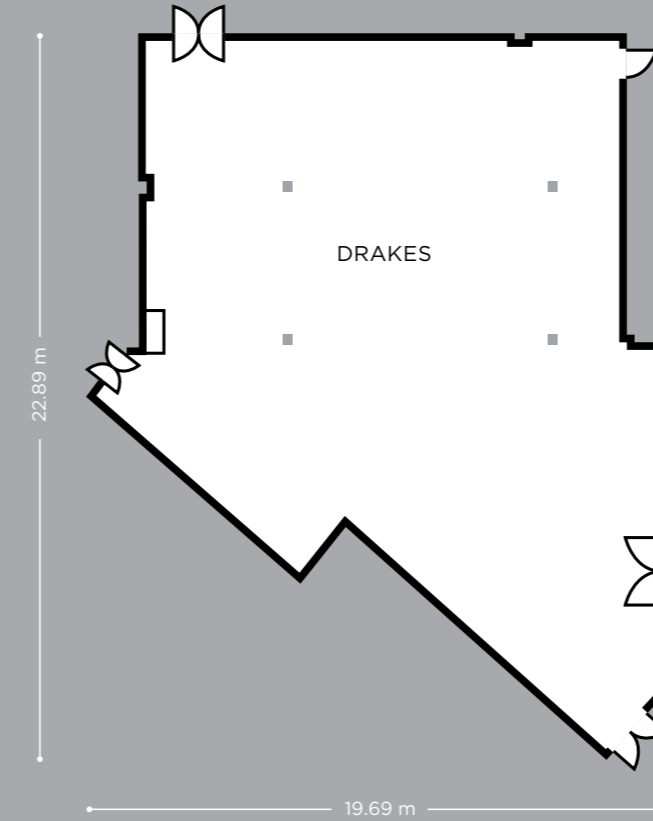

## CAPACITIES AND DIMENSIONS

Room	Theatre	Boardroom	U-shape	Classroom	Cabaret	Reception	Dinner	DinnerDance	Area sq m	Dimensions m		Dimensions ft	
										L x W x H	L x W x H		
<b>LOBBY LEVEL</b>													
Drakes	180	40	40	100	80	300	180	140	333	22.89 x 19.69 x 2.49		3,584 75' x 64' 7" x 8' 2"	
Private Dining Room	20	12	-	-	-	-	12	-	32	4.74 x 6.83 x 2.3		344 15' 6" x 22' 5" x 7' 7"	
<b>MARINA LEVEL</b>													
Grand Room (1, 2 & 3)	400	-	-	350	280	800	500	400	564	34 x 16.6 x 2.9		6,070 111' 6" x 54' 5" x 9' 6"	
Grand Room 1	120	40	45	95	96	200	120	90	213	18.84 x 11.35 x 2.9		2,292 61' 10" x 37' 3" x 9' 6"	
Grand Room 2	200	40	48	113	120	350	170	120	232	17.89 x 12.99 x 2.9		2,497 58' 8" x 42' 7" x 9' 6"	
Grand Room 3	150	40	40	90	96	200	120	90	176	17.89 x 9.88 x 2.9		1,894 58' 8" x 32' 5" x 9' 6"	
Grand Foyer	-	-	-	-	-	500	-	-	266	34 x 10 x 2.3		2,863 111' 6" x 32' 9"	
Grand Boardroom 1	-	10	10	-	-	-	10	-	24.44	5.2 x 4.7		263 17' x 15' 5"	
Grand Boardroom 2	-	10	6	-	-	-	6	-	22.75	6.5 x 3.5		244 21' 4" x 11' 6"	
Grand Boardroom 3	-	10	6	-	-	-	6	-	16.8	4.8 x 3.5		180 15' 9" x 11'	
<b>PENTHOUSE LEVEL</b>													
The Bridges	80	30	30	30	42	80	70	-	119	14.51 x 8.26 x 2.3		1,280 47' 7" x 27' 1" x 7' 7"	
Albert	25	14	10	12	12	30	20	-	37	5.97 x 6.3 x 2.3		398 19' 7" x 20' 8" x 7' 7"	
Battersea	60	20	24	24	30	50	50	-	67	8.13 x 8.26 x 2.3		721 26' 8" x 27' 1" x 7' 7"	
Boardroom	-	12	-	-	-	12	12	-	32	9.62 x 3.4 x 2.3		344 31' 7" x 11' 2" x 7' 7"	



Chelsea Riverside Brasserie - lounge and bar

Wyndham Grand London  
Chelsea Harbour

London SW10 0XG  
United Kingdom  
Tel +44 (0)20 7823 3000  
Fax +44 (0)20 7351 6525

For exclusive privileges and  
more information, please visit  
[wyndhamgrandlondon.co.uk](http://wyndhamgrandlondon.co.uk)  
[chelseariversidebrasserie.co.uk](http://chelseariversidebrasserie.co.uk)  
[blueharbourspa.co.uk](http://blueharbourspa.co.uk)



**WYNDHAM GRAND**  
LONDON CHELSEA HARBOUR